

ELNSM54M-HC-HV Series



**MBB HC
MONOCRYSTALLINE
PV MODULE
400-415W**



Sirius 182M Series

Elin redefined the high efficiency module series by combining 182 mm silicon wafer, multi busbar and Halfcell technology. With the Sirius 182M, it has effectively combined technology, extremely improving module efficiency and power output.

KEY FEATURES



Less mismatch to get more power



Less power loss by minimizing the shading impact



Competitive low light performance



Ideal choice for utility and commercial scale projects by reduced BOS and improve ROI.



In stringent environment condition :
 • sand, acid, and alkali, hail stones,
 • 2400pa wind load and 5400pa snow load.
 • PID FREE

QUALITY SYSTEM



ISO 9001:2015, ISO 14001:2015, ISO 45001: 2018, ISO 27001:2013, ISO 10002: 2018, ISO 26000:2021, ISO 37001:2016, ISO 50001:2018

PRODUCT CERTIFICATION



TS EN 61215, TS EN 61730
 IEC 61215, IEC 61730, IEC 62804 (PID FREE)
 UL 61730-1, UL 61730-2

WARRANTY



12 YEARS Guarantee On Product



25 YEARS Linear Power Output Warranty

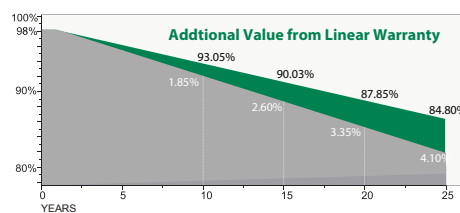

ELNSM54M-HC-HV Series

ELECTRICAL SPECIFICATIONS

Module Type	ELNSM54M-400-HC-HV		ELNSM54M-405-HC-HV		ELNSM54M-410-HC-HV		ELNSM54M-415-HC-HV	
	STC	NOCT	STC	NOCT	STC	NOCT	STC	NOCT
STC Maximum Power (Pmp)	400	301	405	304	410	308	415	311
Open Circuit Voltage (Voc)	37.12	34.64	37.22	34.73	37.32	34.81	37.42	34.90
Open Circuit Voltage (Isc)	13.60	10.99	13.70	11.07	13.80	11.15	13.90	11.23
Maximum Power Voltage (Vmp)	30.81	28.82	30.93	28.91	31.05	29.05	31.16	29.19
Maximum Power Current (Imp)	12.99	10.44	13.10	10.51	13.21	10.59	13.32	10.66
STC Module Efficiency (ηm)	20.48		20.74		21.00		21.25	
Power Tolerance	(0, +4,99 W)							
Maximum System Voltage	1500V DC							
Maximum Serial Fuse Value	25 A							

* Measurement Tolerance +/- 3%
 STC: Radiation 1000 W/m² Cell Temperature 25 °C AM = 1.5;
 NOCT: Radiation 800W /m², Ambient Temperature 20 °C, AM = 1.5, Wind Power 1 m/s

TEMPERATURE CHARACTERISTICS

Pmax Temperature Coefficient	-0.34 %/°C
Voc Temperature Coefficient	-0.26 %/°C
Isc Temperature Coefficient	+0.05 %/°C
Operating Temperature	-40 ~ +85 °C
Nominal Operation Cell Temperature (NOCT))	45 ± 2 °C

MECHANICAL SPECIFICATIONS

External Dimension	1722 x 1134 x 35 mm
Weight	19 kg
Solar Cells	PERC Mono Crystal (108 piece)
Glass	3.2 mm AR coated tempered glass
Frame	Anodized Aluminum Alloy
Connection	IP68,3 diode
Output Cables*	4.0 mm ² , 350mm(+)/350mm(-) or Customized Length
Mechanical Resistance	Front Side 5400Pa / Rear Side 2400Pa

* Output cable lengths should be specified during order phase.

PACKING

	20'GP	40'HQ
Container		
Number of piece in one palette	31	31
Number of palettes in one container	5	24
Number of pieces in one container	155	744

ELiN A.Ş. reserves the right to change the technical specifications and design data in the catalog without prior notice.
 Made in Türkiye.

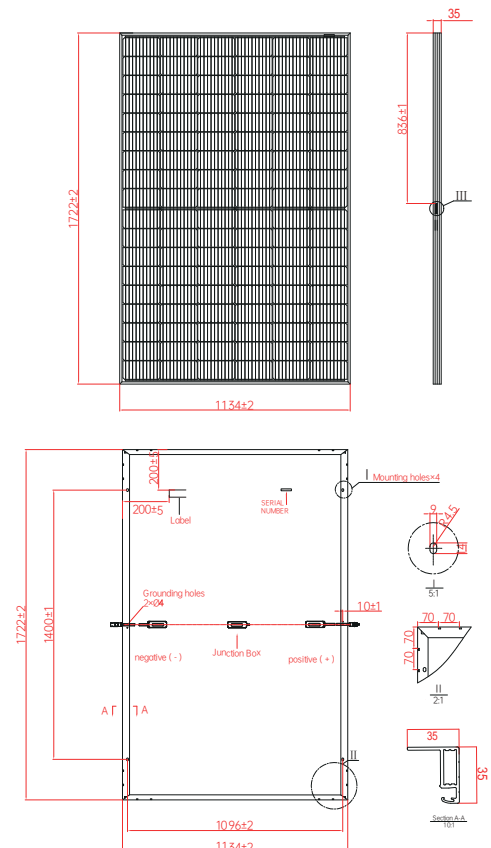

I- V CURVE

